



# 72 ParkSyde

Ghatkopar (E)

The Prime Spot



# 72 ParkSyde

## 2, 3 & 4 BHK Homes and High Street Retail

Reside in the heart of a bold new vision for Ghatkopar. Redefine your future in this exquisite project representing the next frontier in contemporary life. 72 Parksyde is spearheading the movement for an integrated living.

The combination of the luxury homes, abundant amenities and well-connected location make 72 Parksyde a desirable destination.



\*Artist's impression. Only for representation.



\*Artist's impression. Only for representation.

Indoor Games

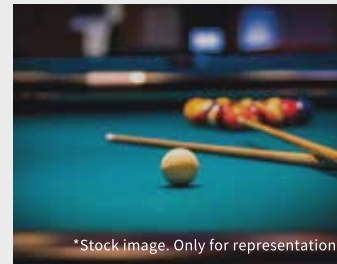

\*Stock image. Only for representation.

Reading Area



\*Stock image. Only for representation.

Children's Play Area

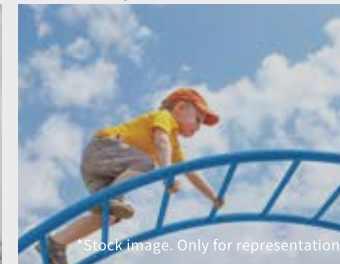

\*Stock image. Only for representation.

Senior Citizen's Area



\*Stock image. Only for representation.



\*Artist's impression. Only for representation.

Multipurpose Hall



\*Stock image. Only for representation.

Yoga & Meditation



\*Stock image. Only for representation.

Fitness Area - Gym

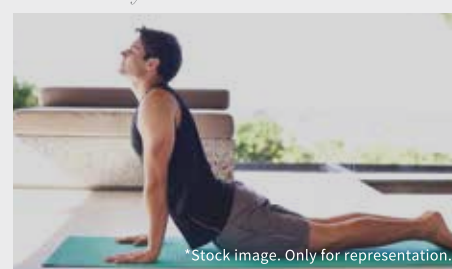

\*Stock image. Only for representation.



\*Stock image. Only for representation.

Landscape Seating Area



\*Stock image. Only for representation.



72 Parksyde is Ghatkopar's most exquisite canvas.

# A Masterpiece

## Tower Amenities

- Earthquake resistant RCC Frame Structure
- Lightweight AAC Blocks
- 2 Nos. Hi-Speed Lifts
- Society Office
- Good Quality Paint
- D.G Back-up - Lifts & Common Areas
- Intercom System
- CCTV Surveillance
- Video Door Phone
- Vitrified Tile Flooring
- Ceramic Tile Flooring
- Anti-skid Flooring
- Ceramic Tile Dado (7')
- Marble Outer Cil
- Granite / Composite Marble Inner Cil
- Granite Platform
- T.W. Frame with Flush Door
- Aluminium Sliding Windows

## Home Amenities

- Gypsum Plaster
- Good Quality Paint
- Ceramic & Sanitary Fittings
- SS Sink
- Concealed Wiring & Plumbing Work
- Modular Switches
- Exhaust Fan-points
- Water-Purifier Point
- Geyser Point
- Washing Machine Point
- AC point
- TV & Telephone Point

3RD FLOOR PLAN

TOWER A



4TH TO 5TH FLOOR PLAN

TOWER A



FLAT NO	TYPE	TOTAL RERA CARPET AREA (INCL. BAL)	
1	2BHK	678.99 SQ.FT	63.08 SQ.MT
2	3BHK	971.13 SQ.FT	90.22 SQ.MT
3	2BHK	741.32 SQ.FT	68.87 SQ.MT
4	2BHK	601.38 SQ.FT	55.87 SQ.MT

6TH TO 8TH AND 10TH TO 14TH FLOOR PLAN

TOWER A



FLAT NO	TYPE	TOTAL RERA CARPET AREA (INCL. BAL)	
1	2BHK	686.42 SQ.FT	63.77 SQ.MT
2	3BHK	1020.43 SQ.FT	94.80 SQ.MT
3	2BHK	829.37 SQ.FT	77.05 SQ.MT
4	2BHK	601.38 SQ.FT	55.87 SQ.MT



## TOWER A

## 9TH REFUGE FLOOR PLAN

FLAT NO	TYPE	TOTAL RERA CARPET AREA (INCL. BAL)	
1	2BHK	686.42 SQ.FT	63.77 SQ.MT
2	3BHK	1020.43 SQ.FT	94.80 SQ.MT
3	REFUGE	N.A	N.A
4	2BHK	601.38 SQ.FT	55.87 SQ.MT



## TOWER A

## 15TH FLOOR PLAN

FLAT NO	TYPE	TOTAL RERA CARPET AREA (INCL. BAL)	
1	2BHK	686.42 SQ.FT	63.77 SQ.MT
2	4BHK	1861.85 SQ.FT	172.97 SQ.MT
3	N.A	N.A	N.A
4	2BHK	601.38 SQ.FT	55.87 SQ.MT



## TOWER A

## 16TH REFUGE FLOOR PLAN

FLAT NO	TYPE	TOTAL RERA CARPET AREA (INCL. BAL)	
1	2BHK	686.42 SQ.FT	63.77 SQ.MT
2	4BHK	1342.16 SQ.FT	124.69 SQ.MT
3	REFUGE	N.A	N.A
4	2BHK	601.38 SQ.FT	55.87 SQ.MT



## TOWER A

## 17TH TO 20TH FLOOR PLAN

FLAT NO	TYPE	TOTAL RERA CARPET AREA (INCL. BAL)	
1	2BHK	759.83 SQ.FT	70.59 SQ.MT
2	3BHK	1100.94 SQ.FT	102.28 SQ.MT
3	2BHK	901.49 SQ.FT	83.75 SQ.MT
4	2BHK	601.38 SQ.FT	55.87 SQ.MT



## TOWER B

## 2ND FLOOR PLAN

FLAT NO	TYPE	TOTAL RERA CARPET AREA (INCL. BAL)	
1	2BHK	N.A	N.A
2	3BHK	961.87 SQ.FT	89.36 SQ.MT
3	2BHK	717.42 SQ.FT	66.65 SQ.MT
4	2BHK	N.A	N.A

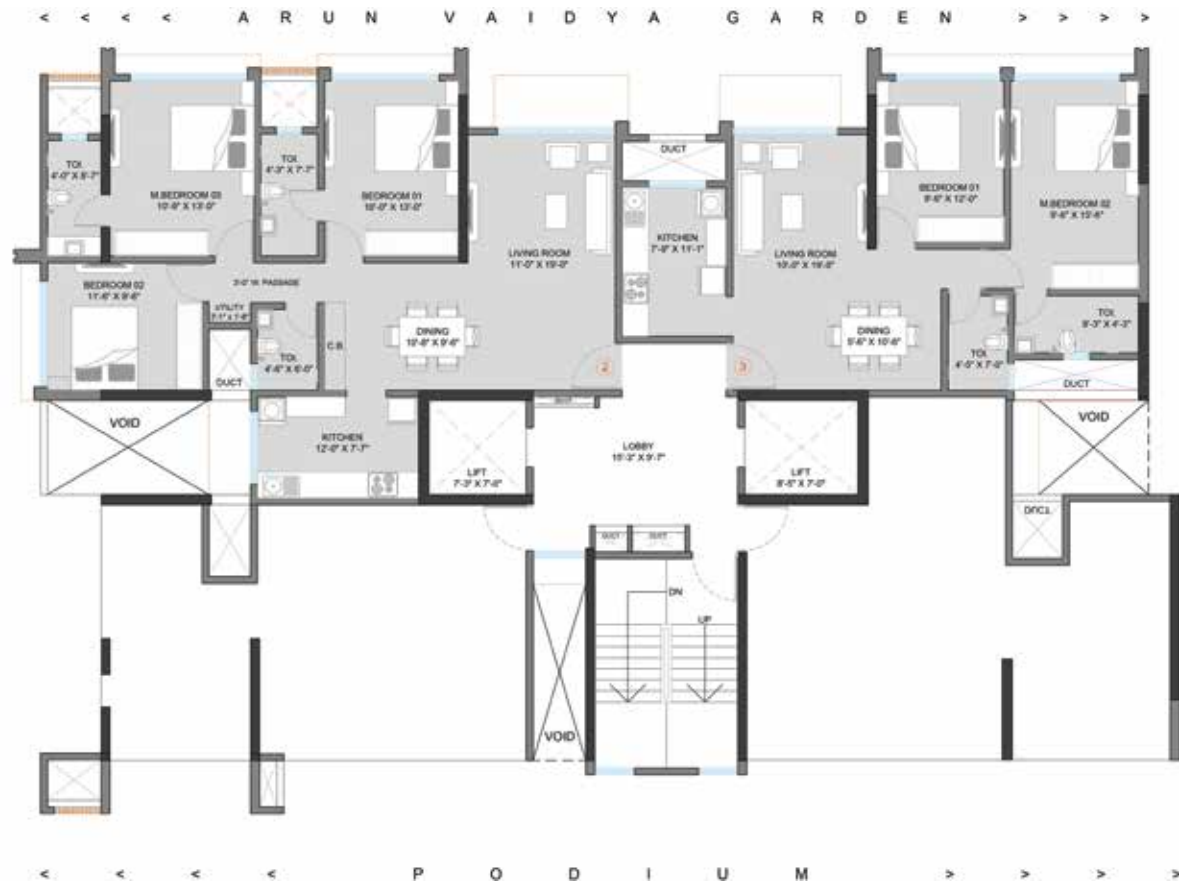

## TOWER B

## 3RD TO 5TH FLOOR PLAN

FLAT NO	TYPE	TOTAL RERA CARPET AREA (INCL. BAL)	
1	2BHK	678.99 SQ.FT	63.08 SQ.MT
2	3BHK	961.87 SQ.FT	89.36 SQ.MT
3	2BHK	717.42 SQ.FT	66.65 SQ.MT
4	2BHK	601.38 SQ.FT	55.87 SQ.MT



## TOWER B

## 6TH TO 8TH AND 10TH TO 15TH FLOOR PLAN

FLAT NO	TYPE	TOTAL RERA CARPET AREA (INCL. BAL)	
1	2BHK	686.42 SQ.FT	63.77 SQ.MT
2	3BHK	1004.93 SQ.FT	93.36 SQ.MT
3	2BHK	813.76 SQ.FT	75.60 SQ.MT
4	2BHK	601.38 SQ.FT	55.87 SQ.MT



## TOWER B

## 9TH REFUGE FLOOR PLAN

FLAT NO	TYPE	TOTAL RERA CARPET AREA (INCL. BAL)	
1	2BHK	686.42 SQ.FT	63.77 SQ.MT
2	3.5BHK	1170.69 SQ.FT	108.76 SQ.MT
3	REFUGE	N.A	N.A
4	2BHK	601.38 SQ.FT	55.87 SQ.MT





## TOWER B

## 16TH REFUGE FLOOR PLAN

FLAT NO	TYPE	TOTAL RERA CARPET AREA (INCL. BAL)	
1	2BHK	686.42 SQ.FT	63.77 SQ.MT
2	4BHK	1559.06 SQ.FT	144.84 SQ.MT
3	REFUGE	N.A	N.A
4	2BHK	601.38 SQ.FT	55.87 SQ.MT



## TOWER B

## 17TH TO 20TH FLOOR PLAN

FLAT NO	TYPE	TOTAL RERA CARPET AREA (INCL. BAL)	
1	2BHK	759.83 SQ.FT	70.59 SQ.MT
2	3BHK	1085.98 SQ.FT	100.89 SQ.MT
3	2BHK	884.59 SQ.FT	82.18 SQ.MT
4	2BHK	601.38 SQ.FT	55.87 SQ.MT



Disclaimer: The plans, designs, and dimensions are as per current sanctioned plans and approvals. Specifications, amenities, and facilities will be as set out in the agreement for sale as uploaded on the RERA website (<https://maharera.mahonline.gov.in>) under Registration No. P51800027845. The same may be subject to modification/change/revision/alteration in terms of approvals, orders, directions and/or regulations of the concerned/relevant authorities, and/or for compliance with laws/regulations in force from time to time and/or in line with our customer policies. We may modify/alter the above by following due procedure as prescribed under the Real Estate (Regulation and Development) Act, 2016, ("RERA") read with the provisions of the Maharashtra Real Estate (Regulation and Development) (Registration of real estate projects, Registration of real estate agents, rates of interest and disclosures on website) Rules, 2017 and the Rules and Regulations framed under RERA for Maharashtra ("RERA Rules").



# Live at the Prime Spot

72 Parksyde offers residents not just homes that capture unobstructed views of the city skyline but also a reputation. It is strategically located in Ghatkopar, a centrally located Mumbai suburb.

## COMMERCIAL DISTRICTS

• Bandra Kurla Complex	5.1 KM	12 minutes
• Powai	6.5 KM	22 minutes
• Andheri MIDC	7.9 KM	25 minutes
• Vashi	9.0 KM	28 minutes
• Prabhadevi	11.3 KM	33 minutes
• Airoli	12.38 KM	21 minutes
• Thane	16.6 KM	27 minutes
• Nariman Point	20.16 KM	43 minutes

## CONNECTIVITY

• Eastern Express Highway	1.1 KM	5 minutes
• Eastern Freeway	2.5 KM	7 minutes
• Chhatrapati Shivaji Maharaj International Airport	4.89 KM	27 minutes
• Bandra Worli Sea link	10.27 KM	31 minutes
• Western Express Highway	12.06 KM	63 minutes
• Navi Mumbai International Airport	19.08 KM	48 minutes

## HOSPITALS

- Parakh Hospital (700 m)
- Ashirwad Hospital (1.3 Km)
- Rajawadi Hospital (1.8 Km)

## MALLS

- R Odeon Mall (350 m)
- Phoenix Market City (3.7 Km)

## TEMPLES

- Ganesh Mandir (800 m)
- Kukreja Jain Derasar (900 m)

## HIGHWAYS

- Eastern Express Highway(1.1 Km)
- LBS Road (2.0 Km)
- Santacruz-Chembur Link Road (3.0 Km)

## PUBLIC TRANSPORT

- Proposed Pantnagar Metro Station (450 m)
- Ghatkopar Station (600 m)
- Ghatkopar Bus Depot (1.5 Km)
- Ghatkopar Metro Station (1.6 km)

## SCHOOLS / COLLEGES

- Garodia P. G. School (1.1 Km)
- Somaiya School & College (1.8 Km)
- RBK International School (2.9 Km)

## GARDENS

- Arun Vaidya Park (150 m)
- Boxplay Sports Arena (700 m)
- Lions Club Garden (1.0 Km)

## MULTIPLEXES

- PVR Cinemas (350 m)
- Ghatkopar Inox (650 m)

Source: Google Maps



**72 ParkSyde**  
The Prime Spot

**RBK International Academy**

\*MAP NOT TO SCALE



# 72 ParkSyde

Ghatkopar (E)

The Prime Spot

Site:  
72 Parksyde, Hingwala lane, Behind Siddhivinayak  
temple, Pant Nagar, Ghatkopar (East),  
Mumbai 400 075

Office:  
Adeshwar Associates NX, Sai Heritage, Level 4,  
Above Axis Bank, Tilak Road, Ghatkopar (East),  
Mumbai 400 077

Website: [www.72parksyde.com](http://www.72parksyde.com) | Email: [info@72parksyde.com](mailto:info@72parksyde.com) | Phone: +91 92777 27272 / 022 6875 7200

"72parksyde has been registered by Adeshwar Associates NX. ("the Promoter") via MahaRERA registration no. P51800027845, the details of which are available on the website <https://maharera.mahaonline.gov.in> under registered projects."

Disclaimer: The information contained herein is indicative and for representation purpose only. The printed material does not constitute an offer and / or contract of any type between the developer/owner and the recipient. All sales / leases shall be governed by the terms of the agreement for sale / lease.